

This drawing and the design it covers are the property of INDRADHANUSH GAS GRID LIMITED. They are merely loaned and on the borrower's express agreement that they will not be reproduced, copied, imitated, exhibited, nor used except in the limited way and private use permitted by any written consent given by lender to the borrower.

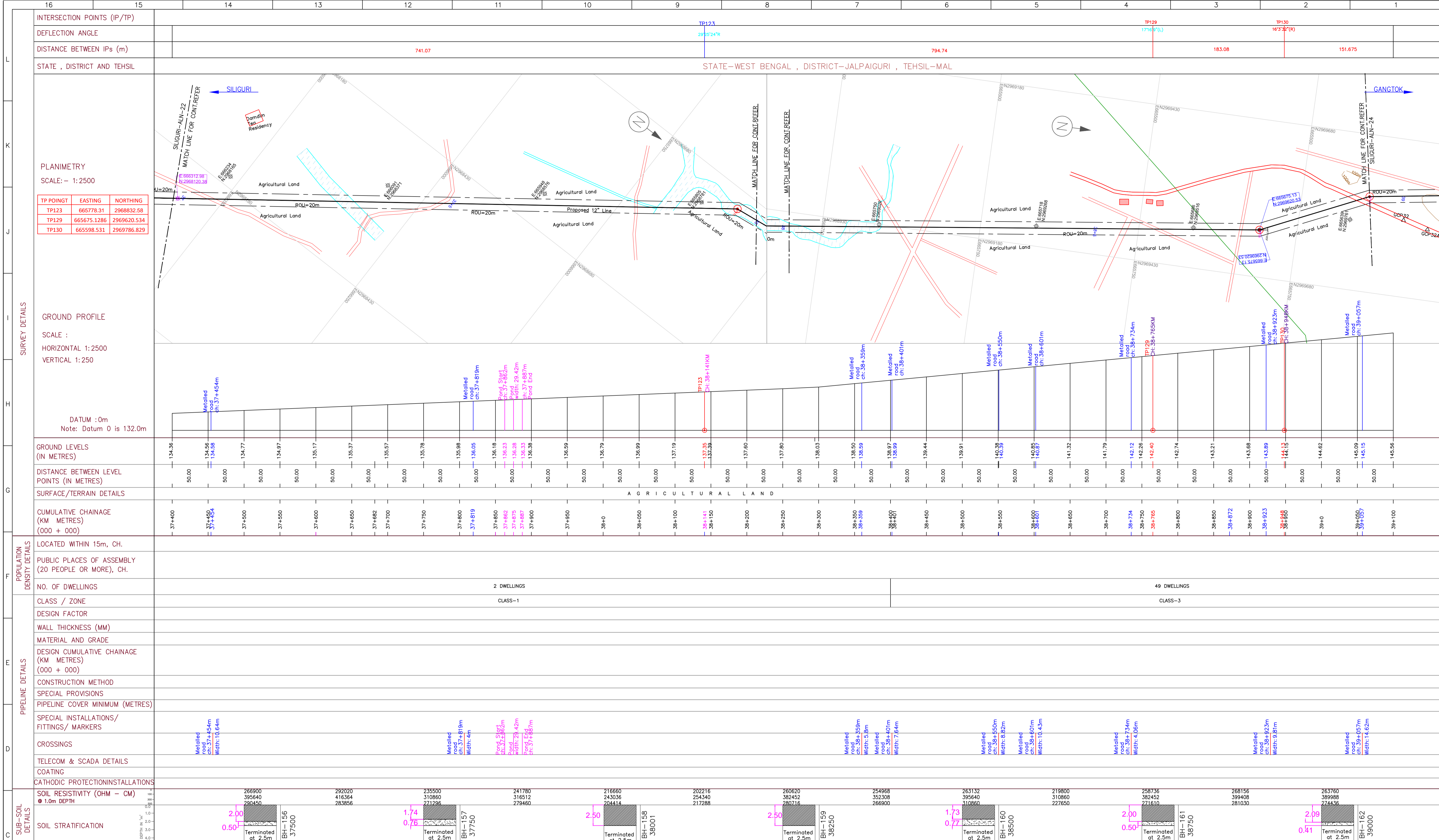

TP POINT	EASTING	NORTHING
TP123	665778.31	2968832.58
TP129	665675.1286	2969620.534
TP130	665598.531	2969786.829

NO. OF DWELLINGS	CLASS / ZONE
2 DWELLINGS	CLASS-1
49 DWELLINGS	CLASS-3

SOIL RESISTIVITY (OHM - CM)	SOIL STRATIFICATION
266900, 395640, 291450	Terminated at 2.5m, BH-156, 37500
292020, 416364, 283856	1.74, 0.76, Terminated at 2.5m, BH-157, 37750
235500, 241780, 217296	2.50, Terminated at 2.5m, BH-158, 38001
216660, 243036, 204414	2.50, Terminated at 2.5m, BH-159, 38250
202216, 254340, 217288	1.73, 0.77, Terminated at 2.5m, BH-160, 38500
260620, 382452, 280716	2.00, 0.50, Terminated at 2.5m, BH-161, 38750
254968, 352308, 266900	2.09, Terminated at 2.5m, BH-162, 39000
263132, 395640, 310660	
219800, 310860, 227650	
258736, 382452, 271610	
268156, 399408, 281030	
263760, 389988, 274436	

CARRIER PIPE	OTHER MATERIALS	DRAWING TITLE	DRAWING NO.
O.D. # WT(mm) COATING LENGTH	DESCRIPTION NUMBER	PIPELINE ROUTE MAP 1:25,000 SCALE	SILIGURI-ROUTEMAP-02
	K.M. POST	CROSS DRAWING	SILIGURI-CRS-DRN-02
	DIRECTIONAL MARKER		
	AERIAL MARKER		
	INSULATING JOINT		
	HOT BENDS		
	NAVIGABLE WATERWAY		
	WARNING SIGN		
	N.H. CROSSING		
	S.H. CROSSING		
	M.D.R. CROSSING		
	OTHER ROAD CROSSING		
	CANAL CROSSING		
	RIVER CROSSING		
	NALA CROSSING		
	RAILWAY CROSSING		

NO.	DATE	REVISIONS	BY	CHKD	APPD.
0	4-03-22	DRAFT COPY	X. RAJANATH	P. S. Rao	
1		FINAL COPY	X. RAJANATH	P. S. Rao	

DRAWING TITLE	DRAWING NO.	SCALE	DRAWING NO.	SHEET NO.	REV.
SILIGURI-ALN-23		1:2500		23 OF 109	0

ISSUED FOR BID